

# PETROLYMPIC

VAUQUELIN & RAYON D'OR GOLD PROPERTIES - QUEBEC

## VAUQUELIN GOLD PROPERTY OUTLINED

### Technical Information:

Vauquelin gold property is located east of the Val d'Or mining camp, province of Quebec. The Property consists of 31 contiguous map-designated claims (cells) covering 1,784 Ha in the center of Vauquelin township (NTS 32C03) approximately 40 km east of the town of Val d'Or, a major gold mining center in Northwestern Quebec.

The Property is underlain mainly by intermediate to mafic volcanic rocks with associated synvolcanic intrusions of the Val d'Or Formation and by the Pershing-Manitou granitic pluton in the northeastern extremity of the claim block.

A series of electromagnetic anomalies (Input) are scattered throughout the central part of the Property indicating the possible presence of prospective mineralized zones in those areas.

A northwest-trending fault associated with a gold occurrence is crossing the western boundary and any extension on the Property needs further investigation. A similar northwest-striking gold structure extends immediately to the south of the claim block and may extend on the western part of the Property. Approximately 7 km to the west along the same structure, the Forsan-Exxeter gold zone is also oriented towards the northwest and may extend up to the Property. This gold zone has historical resources totalling 393,869 Mt grading 4.91 g/t Au (Source: L. Perron, 1988, GM-47652 at MERN).

Looking further towards the west of the Property along the same east-west deformed geological units, several base metal and gold showings are present along with the old Bevcon mine which produced between 1945 and 1967 a total of 438,000 ounces of gold grading 4.3 g/t Au (Source: SIGEOM/MERN).

Approximately 4.5 km south of the Property, an east-west trending mineralized structure hosts the old Chimo mine with indicated resources of 4,017,600 tonnes at an average grade of 4.53 g/t Au and inferred resources of 4,877,900 tonnes at an average grade of 3.82 g/t Au (Source: Cartier Resources Inc. press release dated May 5, 2020).

An east-west trending structure to the north of the Property includes the Croinor gold deposit containing proven and probable reserves totalling 602,994 tonnes at a grade of 6.66 g/t Au (Source: Monarch Gold Corporation website).

The Property is located within a very favorable geological and structural environment already hosting several gold-bearing zones and gold mines. An exploration program including geological

and geophysical surveys is necessary to generate targets for a drilling program that could lead to the discovery of gold mineralized zones on the Property.

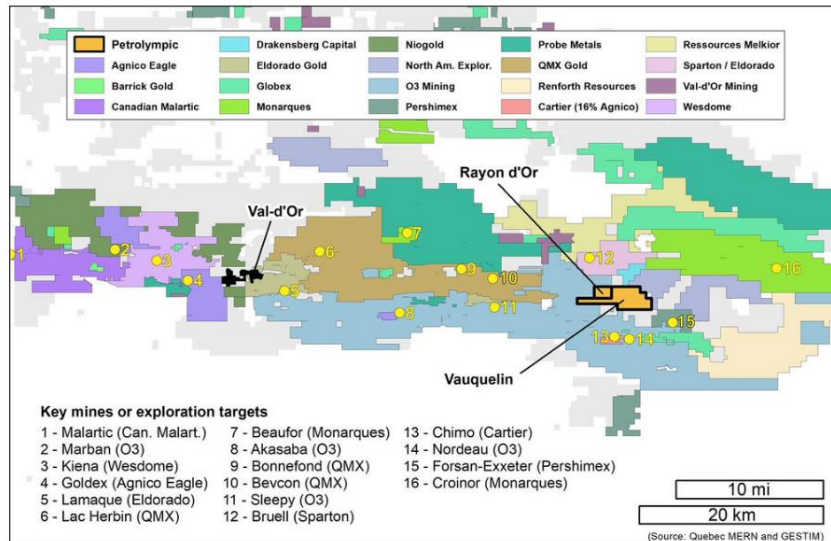

Previous work carried out on the property has shown intersections of gold in some holes.

The presence of dominant NE and NW structural features on the property enhances the potential of this gold property.

In the immediate vicinity, there is the Rayon d'Or gold deposit as well as the showing gold from Lac Guegen-Baie SW, the latter having been discovered in hole 82-6 (2.0 g/t Au over 1.8m) which is located inside the Vauquelin property.

A Megateam-type airborne survey covered the entire property. This survey locate 34 INPUT-type anomalies on the property varying in intensity from 2 to 6 channels. The majority of these electromagnetic anomalies were not investigated during previous exploration drilling campaigns. The orientation of electromagnetic anomalies suggests their association with NE and NW structures which in this sector are generally suitable for gold anomalies. The majority of these anomalies have not been tested earlier.

A series of Input-type EM anomalies runs along the contact between the pluton Pershing-Manitou with volcanics and these anomalies which are oriented WNW may coincide with a mineralized structure.

Other anomalies located inside the pluton that do not correspond to a diabase dyke, have never been drilled in the past and represent targets for gold exploration.

A compilation of surveys carried out in the past on the property as well as the presence of many INPUT- type electromagnetic anomalies distributed over the entire property indicate the possibility of uncovering new gold structures.

Previous work indicates that 15 diamond drill holes totalling 2.853 meters have been completed on the property in the past.

Quartz-tourmaline-pyrite veinlets associated with shear zones are mentioned in some drill holes carried out to verify geophysical anomalies detected in the pluton. These mineralized zones have not been analyzed for gold (GM-38615). The Quartz-tourmaline-pyrite veins represent one of the main mineralization type in Val D'Or area.

Another survey (V-89-82) carried out in the pluton returned an anomalous value of 0.23 g/t Au over 0.9m associated with a diorite mineralized in pyrite.

The best gold intersection intersected on the property graded 2.0 g/t Au over 1.8m in drill hole 82-6, at a depth between 27.01m and 28.81m along the hole. This gold zone was obtained in a shear zone intersecting a unit of felsic volcanic (Rhyolite and quartz-biotite schist) and containing quartz-pyrite veins.

This gold structure may be the southeast extension of the host structure of the Rayon d'Or, vein-type deposit. Historical polls mention two gold zones, one of which is associated with quartz-carbonate-tourmalinepyrite veins in a porphyritic andesite and the other is contained in a quartz-chlorite-tourmaline-pyrite vein.

The best gold intersections of the Rayon d'Or deposit were 3.37 g/t Au over 3.44m in hole V-89-75 (GM-48791) and 12.34 g / t Au over 4.0m in hole M-1.

The property is located in the canton of Vauquelin that represents an exploration area with high potential for gold along the east-west corridor containing the majority of mineralized showings and mines in the Val d'Or region and the presence of structures intersecting volcanics units, in neighboring properties that host gold deposits. Several Megattem-type electromagnetic anomalies distributed over the entire property have never been investigated by surveys. A gold zone is present on the property and coincides with a large zone of shear containing quartz-pyrite veins in a rhyolite and which returned a value of 2.0 g / t Au over 1.8m in hole 82-6. It is recommended to complete the compilation of existing data, making sure to correctly locate the holes that returned gold values, especially hole 82- 6, as well as areas where there are electromagnetic anomalies. Geophysical surveys (Magnetic and IP) should be carried out in order to locate the geological discontinuities and the presence of disseminated sulphides in order to determine potential targets to be investigated during drilling work.

## MAPS

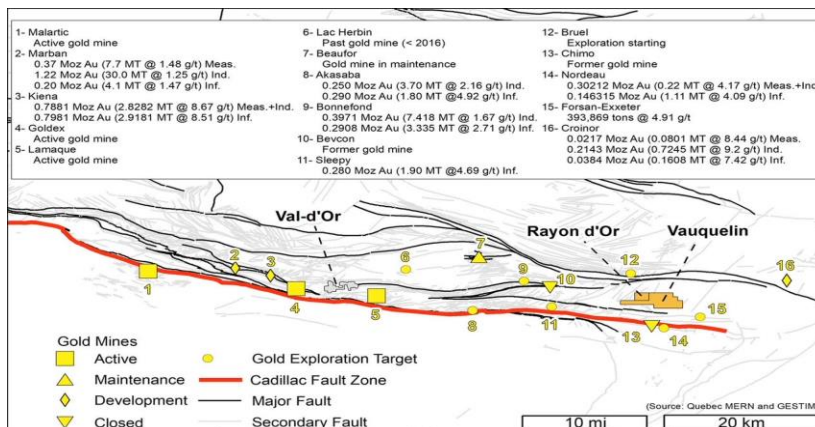

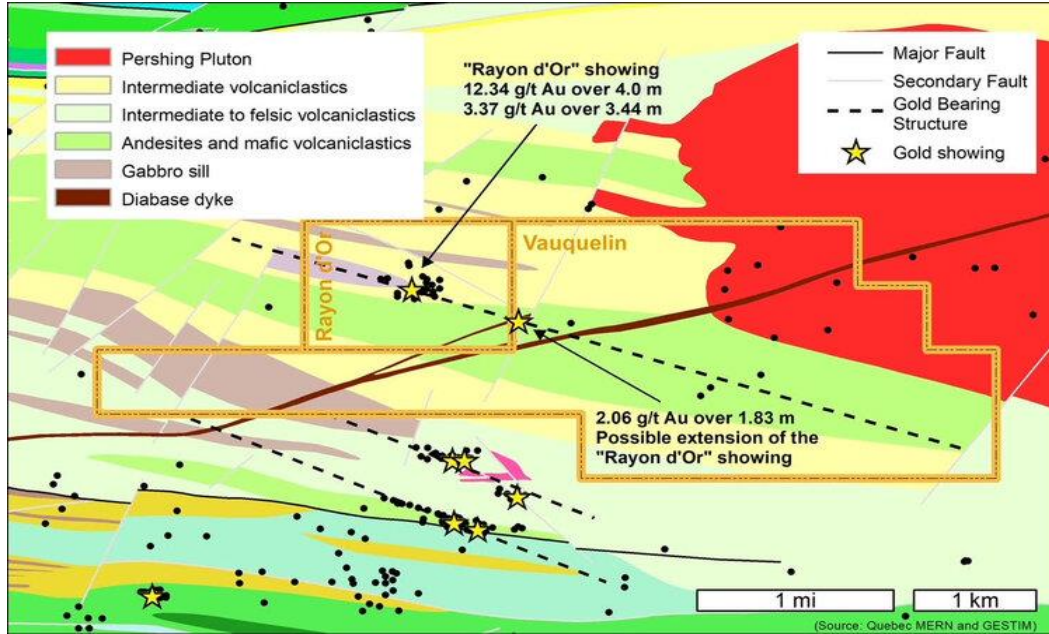

### Resource Area Map

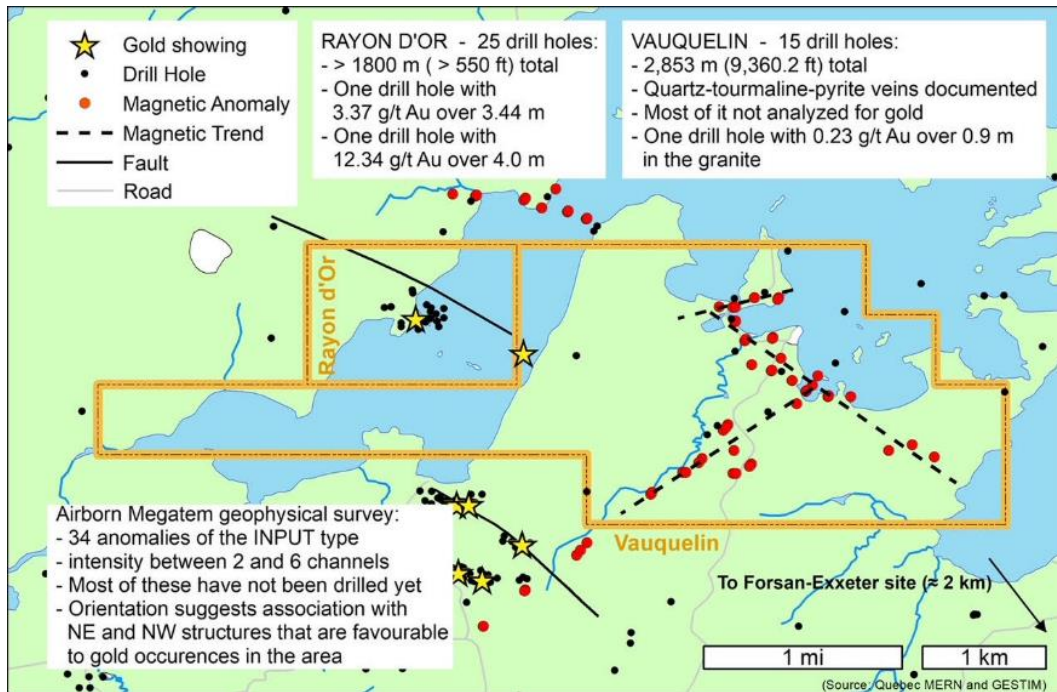

### Geophysical Survey Map